

A0 INSTALLATION DRAWING

IF THIS DOCUMENT IS PRINTED IN HARD COPY, IT IS FOR INFORMATION USE ONLY AND THEREFORE IS NOT SUBJECT TO UPDATING CONTROLS. ALWAYS REFER TO SOLIDWORKS VIEWER FOR LATEST ISSUE

FIRST ANGLE PROJECTION

THIS DRAWING IS CONFIDENTIAL AND IS SUPPLIED ON THE EXPRESS CONDITION THAT IT SHALL NOT BE LOANED OR COPIED OR DISCLOSED TO ANY OTHER PERSON OR USED FOR ANY OTHER PURPOSE WITHOUT THE WRITTEN CONSENT OF AP RACING LTD.



AP Racing
Wheler Road
Coventry
CV3 4LB

Tel: +44 024 7663 9595
Fax: +44 024 7663 9559
e-mail: sales@apracings.co.uk
© AP Racing Ltd. 2005
Web site: HTTP://www.apracings.com

GENERAL DESCRIPTION

THIS UNIQUE PULL TYPE DESIGN ALLOWS THE PUSHROD TO REMAIN STRAIGHT, ELIMINATING ALL SIDE LOADS MAKING IT THE MOST EFFICIENT PEDAL BOX ON THE MARKET. THE CYLINDERS ARE MOUNTED UNDER THE DRIVERS FEET FOR OPTIMUM SPACE UTILISATION AND ACCESS. MINIMUM HYSTERESIS AND BALANCE VARIATION ARE ASSURED BY THE USE OF NEEDLE ROLLER BEARINGS IN THE CENTRE TRUNNION.

FEATURES

- LIGHTWEIGHT ALUMINIUM BASE, MACHINED FROM SOLID.
- ALL PEDALS ARE MACHINED FROM ALUMINIUM BILLET BRAKE PEDAL IS PIVOTED BY BALL BEARINGS TO INCREASE SMOOTHNESS.
- DESIGNED FOR USE WITH CP6465 MASTER CYLINDERS.
- ADJUSTABLE FOOT PADS FOR EXTRA DRIVER COMFORT.
- ADJUSTABLE THROTTLE PEDAL POSITION, LINKAGE WITH A DOUBLE TORSION SPRING FOR A POSITIVE PEDAL RETURN.
- ADJUSTABLE PEDAL STOPS ON CLUTCH AND TROTTLE.
- BRAKE AND CLUTCH PEDAL RATIO 4.8 : 1.
- ALL THREADS METRIC.
- WEIGHT 3.4 KG APPROX WITHOUT CYLINDERS, 4.15KG APPROX WITH CYLINDERS.

PART NUMBER

CP5516-7 - PEDAL BOX BRAKE, CLUTCH AND THROTTLE PEDAL.

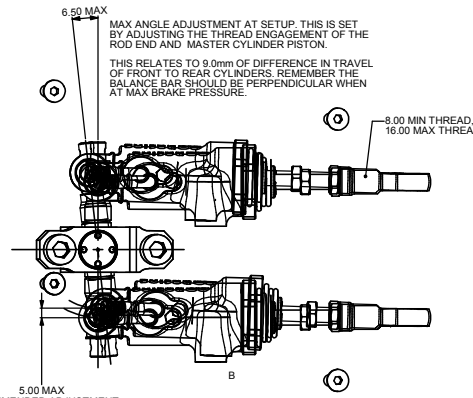
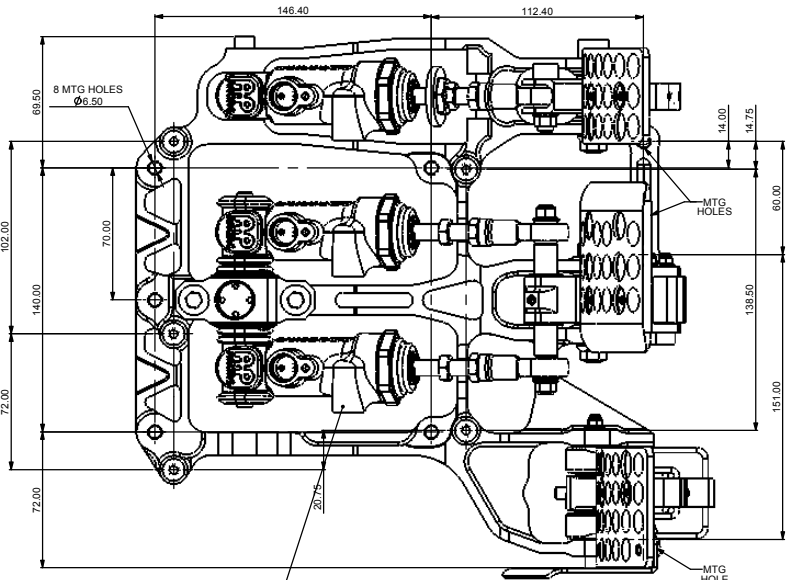
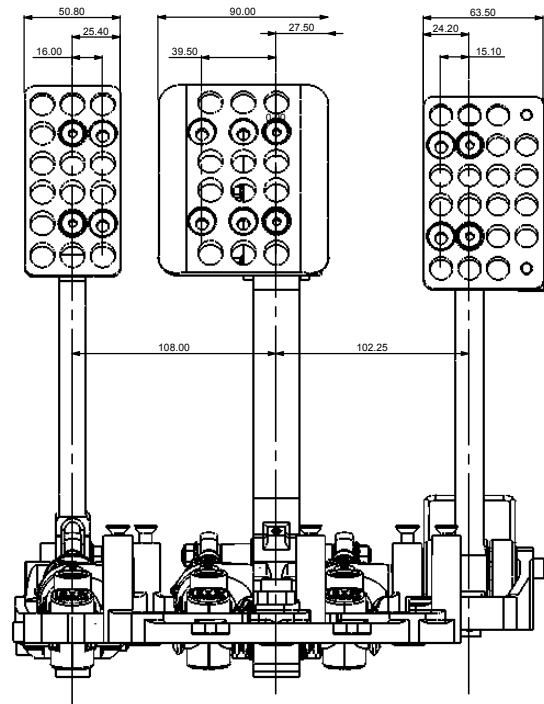
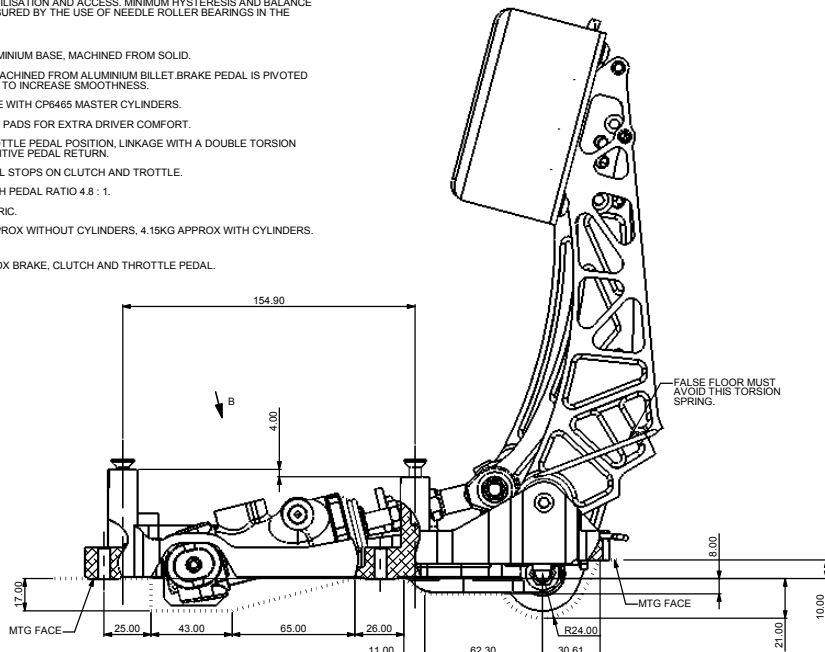

5.00 MAX RECOMMENDED ADJUSTMENT. THE MORE ADJUSTMENT YOU HAVE THE MORE EFFICIENT THE BALANCE BAR BECOMES.

SETTING UP THE BALANCE BAR

ADJUST THE PUSHRODS SO THAT THE BALANCE BAR IS PERPENDICULAR TO THE PUSHRODS UNDER MAXIMUM LOAD. THE SYSTEM IS THEN SQUARE. IT IS NOT IMPORTANT THAT THE SYSTEM IS SQUARE WHEN RELEASED, BUT IT HAS TO BE UNDER LOAD.

FOR MAXIMUM EFFICIENCY IT IS RECOMMENDED THAT THE PEDAL IS AT RIGHT ANGLE WITH THE PUSHRODS UNDER MAXIMUM BRAKING LOAD, AND ALSO KEEPING THE BALANCE BAR CENTRAL WITH BETTER SELECTION OF MASTER CYLINDER SIZES HELPS REDUCE INEFFICIENCIES.

ALSO MAKE SURE THAT THE MASTER-CYLINDER PISTONS FULLY RETURN BEFORE USE. THIS CAN BE CHECKED BY FEELING THE PUSHRODS FOR SLIGHT MOVEMENTS THERE SHOULD NOT BE ANY EXCESSIVE LOOSE MOVEMENT.

PEDAL BOX IS DESIGNED TO SUIT CP6465 HIGH EFFICIENCY MASTER CYLINDERS. FEATURES:
- BUILT IN LOW FRICTION CLEVIS.
- SPECIAL INLET TO ALLOW A LOW FITTING.
- 110x1.0 OUTLET PORT, SET AT 90 Deg.
- 25.4mm OF STROKE.

MASTER CYLINDERS ARE NOT SUPPLIED WITH THIS PEDAL BOX.

| Alterations | | Zone | Issue |
|-------------|-------------------|------|-------|
| Date & No. | Particulars | | # |
| 12/08/2008 | B5289 FIRST ISSUE | | COA |

| | |
|---|--------------|
| SCALE 1:1 | SHEET 3 OF 3 |
| DRAWN Chris Arrowsmith | |
| APPROVED | |
| DERRIVED FROM | |
| TITLE FLOOR MTG REVERSE PULL TYPE PEDAL BOX | |
| DRG NO. CP5516-7CD | |

A0 INSTALLATION DRAWING

IF THIS DOCUMENT IS PRINTED IN HARD COPY, IT IS FOR INFORMATION USE ONLY AND THEREFORE IS NOT SUBJECT TO UPDATING CONTROLS. ALWAYS REFER TO SOLIDWORKS VIEWER FOR LATEST ISSUE



FIRST ANGLE PROJECTION

THIS DRAWING IS CONFIDENTIAL AND IS SUPPLIED ON THE EXPRESS CONDITION THAT IT SHALL NOT BE LOANED OR COPIED OR DISCLOSED TO ANY OTHER PERSON OR USED FOR ANY OTHER PURPOSE WITHOUT THE WRITTEN CONSENT OF AP RACING LTD.



AP Racing
Wheller Road
Coventry
CV3 4LB
Tel: +44 024 7663 9595
Fax: +44 024 7663 9599
e-mail: sales@aprac.com
Web site: HTTP://www.aprac.com

Alterations

| Date & No. | Particulars | Zone | Initials |
|------------|--------------------------------|------|----------|
| | SEE SHEET 1 FOR ISSUE CHANGES. | | |

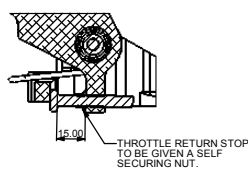
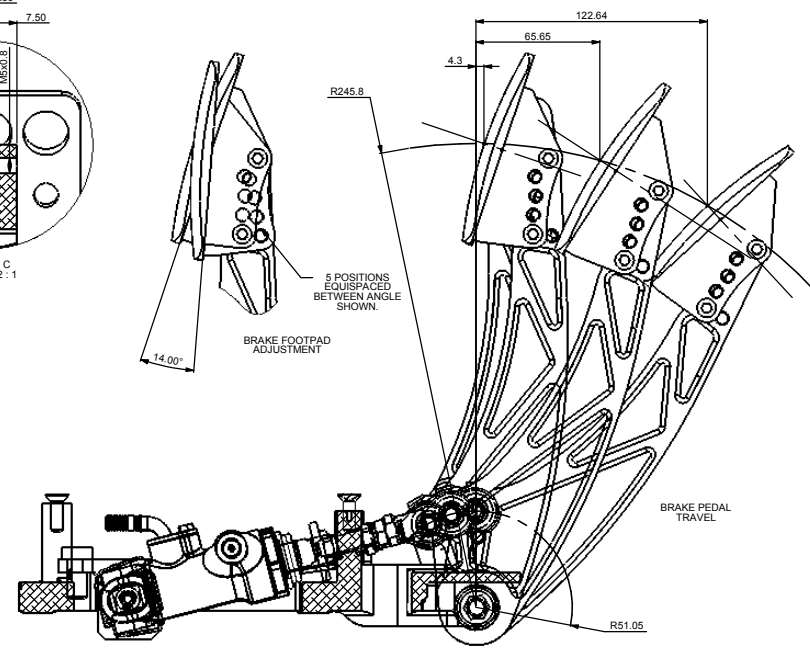
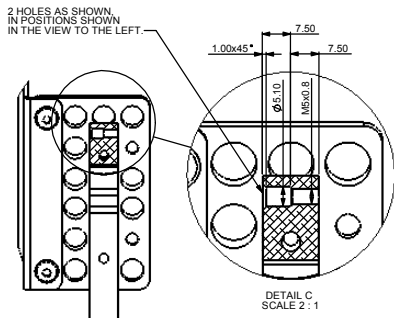
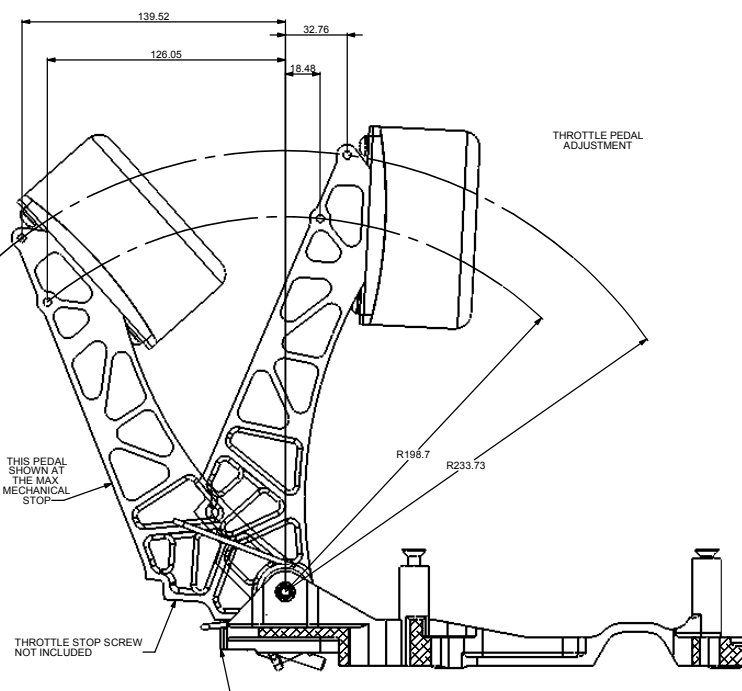

PEDAL BOXES WILL BE SUPPLIED WITH FOOT PADS LOCATED AS SHOWN

CLUTCH STOP WILL BE FITTED TO THE FOOT PAD TO PREVENT IT FROM BEING LOST.

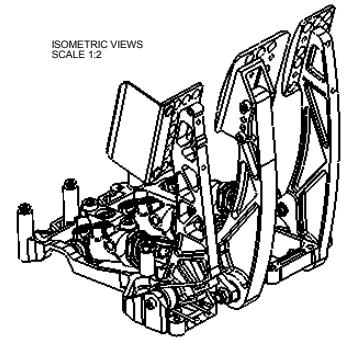
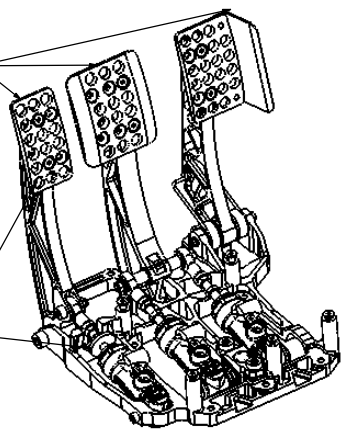
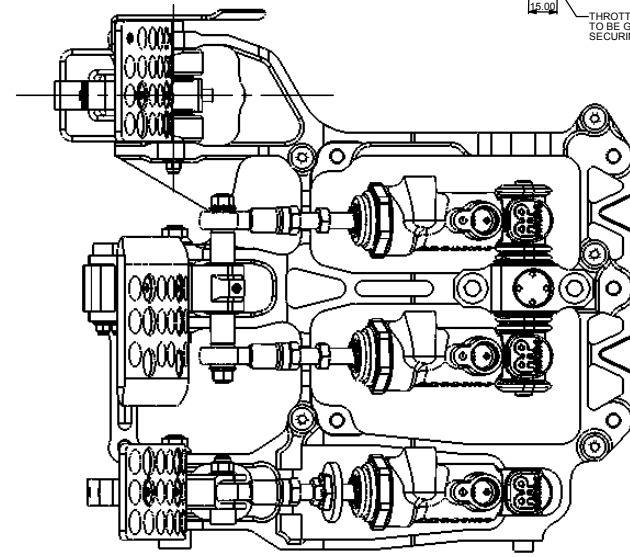

| | |
|---|------------------|
| SCALE 1:1 | SHEET 3 OF 3 |
| DRAWN | Chris Arrowsmith |
| APPROVED | |
| DERIVED FROM | |
| TITLE FLOOR MTG REVERSE PULL TYPE PEDAL BOX | |
| DRG NO. | CP5516-7CD |

A0 INSTALLATION DRAWING

IF THIS DOCUMENT IS PRINTED IN HARDCOPY, IT IS FOR INFORMATION USE ONLY AND THEREFORE IS NOT SUBJECT TO UPDATING CONTROLS. ALWAYS REFER TO SOLIDWORKS VIEWER FOR LATEST ISSUE



FIRST ANGLE PROJECTION

THIS DRAWING IS CONFIDENTIAL AND IS SUPPLIED ON THE EXPRESS CONDITION THAT IT SHALL NOT BE LOANED OR COPIED OR DISCLOSED TO ANY OTHER PERSON OR USED FOR ANY OTHER PURPOSE WITHOUT THE WRITTEN CONSENT OF AP RACING LTD.



AP Racing
Whelley Road
Coventry
CV3 4LB

Tel: +44 024 7663 9595
Fax: +44 024 7663 9559
e-mail: sales@aprac.com

© AP Racing Ltd. 2005 Web site: HTTP://www.aprac.com

| Alterations | | |
|-------------|--------------------------------|------|
| Date & No. | Particulars | Zone |
| # | SEE SHEET 1 FOR ISSUE CHANGES. | # |

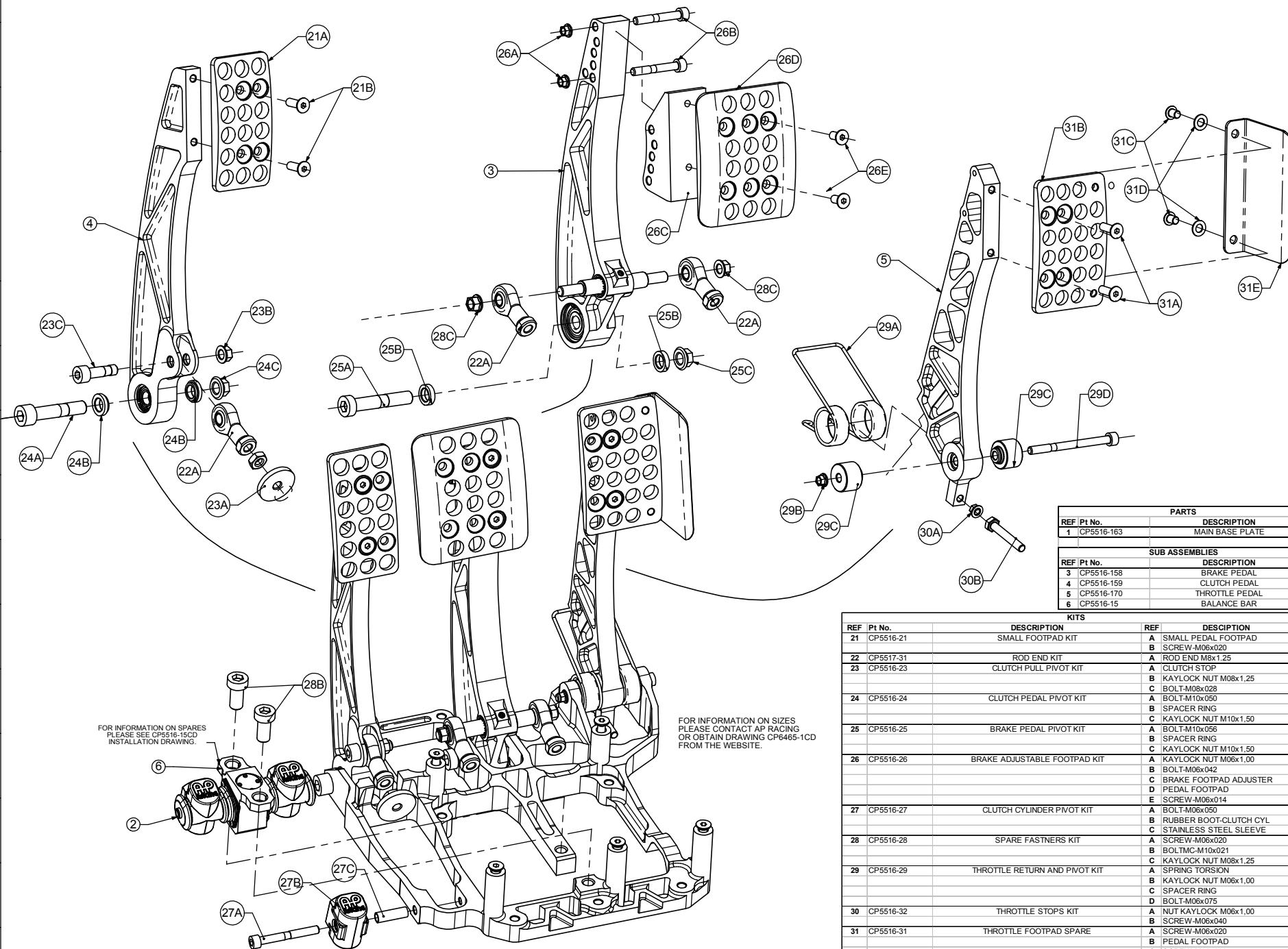

| PARTS | |
|------------|----------------------------|
| REF Pt No. | DESCRIPTION |
| 1 | CP5516-163 MAIN BASE PLATE |

| SUB ASSEMBLIES | |
|----------------|---------------------------|
| REF Pt No. | DESCRIPTION |
| 3 | CP5516-158 BRAKE PEDAL |
| 4 | CP5516-159 CLUTCH PEDAL |
| 5 | CP5516-170 THROTTLE PEDAL |
| 6 | CP5516-15 BALANCE BAR |

| KITS | | | | |
|------------|---|-----|------------------------|-----|
| REF Pt No. | DESCRIPTION | REF | DESCRIPTION | QTY |
| 21 | CP5516-21 SMALL FOOTPAD KIT | A | SMALL PEDAL FOOTPAD | 1 |
| | | B | SCREW-M06x020 | 2 |
| 22 | CP5516-31 ROD END KIT | A | ROD END M8x1.25 | 3 |
| 23 | CP5516-23 CLUTCH PULL PIVOT KIT | A | CLUTCH STOP | 1 |
| | | B | KAYLOCK NUT M08x1.25 | 1 |
| | | C | BOLT-M08x028 | 1 |
| 24 | CP5516-24 CLUTCH PEDAL PIVOT KIT | A | BOLT-M10x050 | 1 |
| | | B | SPACER RING | 2 |
| | | C | KAYLOCK NUT M10x1.50 | 1 |
| 25 | CP5516-25 BRAKE PEDAL PIVOT KIT | A | BOLT-M10x056 | 1 |
| | | B | SPACER RING | 2 |
| | | C | KAYLOCK NUT M10x1.50 | 1 |
| 26 | CP5516-26 BRAKE ADJUSTABLE FOOTPAD KIT | A | KAYLOCK NUT M06x1.00 | 2 |
| | | B | BOLT-M06x042 | 2 |
| | | C | BRAKE FOOTPAD ADJUSTER | 1 |
| | | D | PEDAL FOOTPAD | 1 |
| | | E | SCREW-M06x014 | 2 |
| 27 | CP5516-27 CLUTCH CYLINDER PIVOT KIT | A | BOLT-M06x050 | 1 |
| | | B | RUBBER BOOT-CLUTCH CYL | 1 |
| | | C | STAINLESS STEEL SLEEVE | 1 |
| 28 | CP5516-28 SPARE FASTNERS KIT | A | SCREW-M06x020 | 5 |
| | | B | BOLTM-M10x021 | 2 |
| | | C | KAYLOCK NUT M08x1.25 | 2 |
| 29 | CP5516-29 THROTTLE RETURN AND PIVOT KIT | A | SPRING TORSION | 1 |
| | | B | KAYLOCK NUT M06x1.00 | 1 |
| | | C | SPACER RING | 2 |
| | | D | BOLT-M08x075 | 1 |
| 30 | CP5516-32 THROTTLE STOPS KIT | A | NUT KAYLOCK M06x1.00 | 2 |
| | | B | SCREW-M06x040 | 1 |
| 31 | CP5516-31 THROTTLE FOOTPAD SPARE | A | SCREW-M06x020 | 2 |
| | | B | PEDAL FOOTPAD | 1 |
| | | C | SCREW-M06x008 | 2 |
| | | D | WASHER-12.5x06.5x0.90 | 2 |
| | | E | THROTTLE GUARD PLATE | 1 |

FOR INFORMATION ON SPARES PLEASE SEE CP5516-15CD INSTALLATION DRAWING.

FOR INFORMATION ON SIZES PLEASE CONTACT AP RACING OR OBTAIN DRAWING CP6465-1CD FROM THE WEBSITE.

| | |
|---|--------------|
| SCALE 1:1 | SHEET 3 OF 3 |
| DRAWN Chris Arrowsmith | |
| APPROVED | |
| DERIVED FROM | |
| TITLE FLOOR MTG REVERSE PULL TYPE PEDAL BOX | |
| DRG NO. CP5516-7CD | |